

**Pitt County Property Record Search**

40090  
220 MAIN ST

COLEMAN, DOROTHY SMITH HEIRS  
PO BOX 811 GRIFTON NC 28530 0811

Total Market Value  
**\$119,351**

**KEY INFORMATION**

Property Use	RES	Lot Number	-
Zoning	R8	Land Class	RES
Land Size	0.21	Legal Description	LT 4B MEREDITH WOODS, SC. 1
Township	GRIFTON	Fire District	EMS
Neighborhood	0004572	Planning Jurisdiction	GN
Municipality	GRIFTON		

**ASSESSMENT DETAILS**

Land Value	\$15,000
Building Value	\$104,351
Misc Improvements Value	\$0
Use Value Deferred	\$0
Total Market Value	\$119,351
Total Taxable Value	\$119,351

**BUILDING DETAILS**

**RESIDENTIAL BUILDING (1)**

Card #	1	Style	02-MOBILE-HOME-CONST(54-MANUFHM)
Living Area	1650	Exterior Wall	AL/VINYL
Internal Wall (1)	DRYWALL	Internal Wall (2)	-
Heat	FA-DUC	A/C	CENT
Bedrooms	3	Full Baths	2
Half Baths	0	Fireplace	0
Garage	N	Carport	N
Grade	C	Foundation	PIERS
Stories	1.00	Year Built	1999
Effective Year Built	2015		

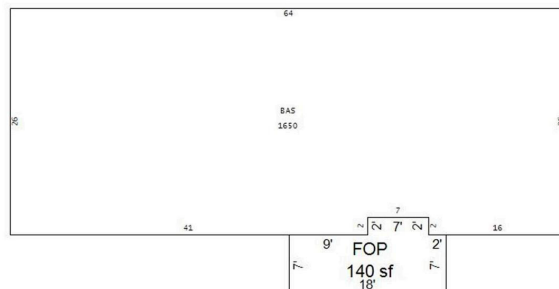

**SALES HISTORY**

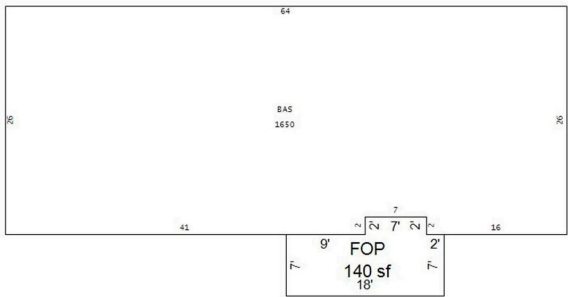
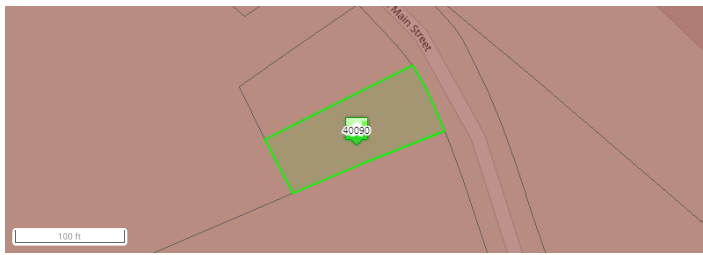

Data last updated: 08/05/2024